

COLORADO LURE COURSING ASSOCIATION

DEANN BRITTON
444 S. LIMA CIRCLE
AURORA, CO 80012
rahwynd@yahoo.com
303-249-2844
www.clcaonline.com
www.asfa.org

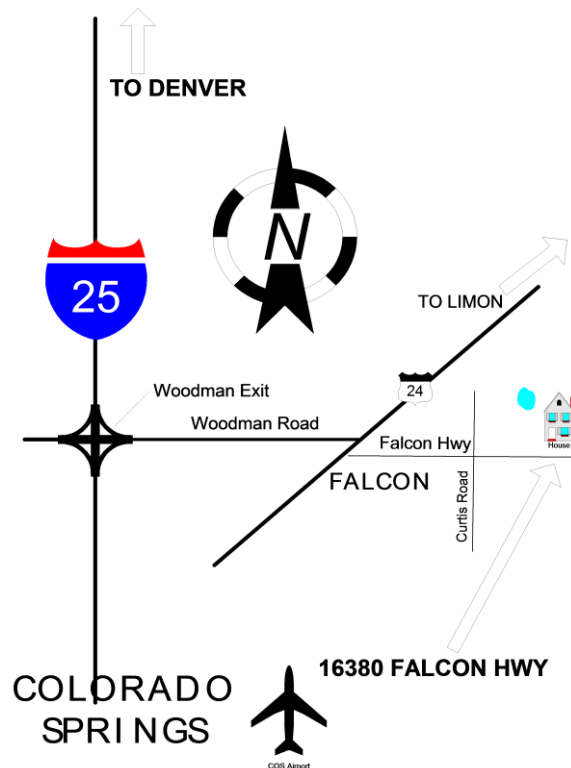

From I-25 North or South: Take Woodmen Road Exit and travel east to Highway 24. Turn Right on Highway 24 and then turn Left on Meridian. Go to stop sign and then Turn Left on Falcon Highway. Turn Left in driveway at 16380 Falcon Highway.

PREMIUM LIST

EARLY ENTRIES close on Wednesday, February 18, 2026, at 6:00pm at the FTS's address:
444 S Lima Circle, Aurora, CO 80012

(Substitutions for lame hounds or bitches in season will be allowed prior to 7:30 A.M. on the day of the trial. Owner of the substituted hound must be the Same as the hound already entered.)

REGION 3 ASFA SANCTIONED ALL BREED LURE FIELD TRIAL



COLORADO LURE COURSING ASSOCIATION

**SATURDAY February 21 &
SUNDAY February 22, 2026**
ALL BREED & Lure Chasing Instinct (LCI)
LCI LIMITED to 15 TOTAL DOGS EACH DAY

FALCON INSTITUTE FOR ADVANCED COURSING STUDIES
16380 FALCON HIGHWAY
PEYTON, COLORADO 80831-7993

EARLY ENTRY FEES: \$17.00 for 1st; \$14.00 for 2nd and \$12.00 each additional hound with same owner.

DAY-OF ENTRY FEES: \$25.00 per hound
Payable in US Funds.

Permission has been granted by the American Sighthound Field Association for the holding of this event under American Sighthound Field Association Rules and Regulations
Samantha Duryee, Chairman
ASFA Scheduling Committee

COLORADO LURE COURSING ASSOCIATION

OFFICERS AND DIRECTORS

President	Darci Kunard
Vice President	Connie Sullivan
Recording Secretary	Robin Phinney
Corresponding Secretary	Stephanie Krick
Treasurer	Deann Britton
Directors-at-Large:	Russ Buhrdorf
	Peter Lowe
	Michele Bisbee
	Gina Hayden
	Megan Lundberg

JUDGES (AND THEIR ASSIGNMENTS)

*Russ Buhrdorf, Colorado Springs, CO Tom Golcher Peyton, CO
Darci Kunard, Reunion, CO Heather Minnich Hudson, WY

S = Single Judge * = Provisional Judge # = Canadian Judge

SATURDAY

JUDGE	A	Az	Ba	B	C	G	IB	IW	IG	L C I	P	R	S	SD	SI	SW	W	S g l	P v l
Russ		*	*	X		X		*		X	X	X						*	
Tom	x				X		X		X	X	X	X	X	X	X	X	X		x
Darci	X	X	X	X	X	X	X	X	X				X	X	X	X	X	X	X

SUNDAY

JUDGE	A	Az	Ba	B	C	G	IB	IW	IG	L C I	P	R	S	SD	SI	SW	W	S G L	P V L
Russ				X						X						X	X	*	X
Tom	X	X	X		X	X	X	X	X	X	X	X							
Darci				X	X	X	X	X	X				X	X	X			X	
Heather	X	X	X								X	X	X	X	X	X	X		X

FIELD COMMITTEE

Field Chair Connie Sullivan cesullivan@comcast.net 303-906-1658
Field Secretary Deann Britton rahwyn@yahoo.com 303-249-2844(# on field)
444 S Lima Circle, Aurora, CO 80012
Lure Operators R. Buhrdorf, T. Golcher, H. Minnich, C. Sullivan, M. Lundberg

Ribbons or rosettes will be offered for all placements.

First=Blue, Second=Red, Third=Yellow, Fourth=White, NBQ=Green

Highest Scoring Singles=Navy/Gold, Best of Breed=Purple/Gold

Best In Field = Blue, Red, White

TRIAL HOURS: 8:00 a.m. until ribbons are awarded.

DAY OF ENTRIES CLOSE AT 8:30 A.M DAY OF TRIAL

ROLL CALL PROMPTLY AT 9:00 A.M.

Any hound not present at Roll Call will be scratched and entry fee will not be refunded.

BEST IN FIELD OFFERED SATURDAY ONLY

ELIGIBLE BREEDS & REGISTRY

Only purebred Afghan Hounds, Azawakhs, Basenjis, Borzoi, Cirneco dell'Etna, Greyhounds, Ibizan Hounds, Irish Wolfhounds, Italian Greyhounds, Pharaoh Hounds, Rhodesian Ridgebacks, Salukis, Scottish Deerhounds, Silken Windhound, Sloughis, Whippets and Provisional breeds may be entered in the regular stakes. Current Provisional include purebred Chart Polski, Galgo Español, Magyar Agar, Peruvian Inca Orchid, Portuguese Podengo (Pequeno), Portuguese Podengo (Medio & Grande), and must be individually registered with the appropriate registry. All entries in the regular stakes shall be individually registered with the American Kennel Club, the National Greyhound Association (NGA), including the United Kennel Club (UKC), the Federation Cynologique Internationale, an ASFA-recognized foreign or ASFA Board approved registry or possess a critique registration number (CRN) from the Society for the Perpetuation of Desert Bred Salukis (SPDBS). Provisional stake entries shall be individually registered with the appropriate registry. (Dogs with an Indefinite Listing Privilege (ILP) or Purebred Alternate Listing (PAL) from the American Kennel Club shall be considered registered with that body.)

REGULAR STAKES OFFERED:

OPEN - Any eligible sighthound, excluding ASFA Field Champions of record that has met ASFA certification requirements.

FIELD CHAMPION - Any ASFA Field Champion

VETERAN - Any eligible sighthound which is 6 years or older on the day of the trial, except Irish Wolfhounds whose age shall be at least 5 years; and Afghans, Ibizans, Rhodesian Ridgebacks, Salukis and Whippets whose age shall be at least 7 years of age and has met ASFA certification requirements. Points go toward V-FCh and V-LCM titles.

SINGLES STAKE: Any eligible sighthound including those disqualified to run in other stakes and provisional breeds. Each hound runs alone. Not eligible for Best of Breed or Best in Field. Hounds are eligible to earn TCP and CPX titles from the Singles stake.

PROVISIONAL - Any eligible sighthound of a provisional breed that has met certification requirements. Not eligible to compete in Best of Breed or Best in field.

LURE CHASING INSTINCT (LCI) STAKE: Open to NON sighthounds and sighthound mixes. All entries shall be individually registered with the AKC (including ILP & PAL) or the UKC. A photocopy of acceptable registry must be submitted with each dog's first ASFA field trial entry. Dogs without a recognized registry number may obtain an ASFA ID number for a \$10 registration fee at time of entry.

Small Open: for dogs 17-1/2 inches or less at the withers and / or brachycephalic ("flat-faced") dogs who have not achieved the title of LCC.

Small Excellent: for dogs 17-1/2 inches or less at the withers and/or brachycephalic dogs who have achieved the title of LCC.

Small Veteran: for dogs 17-1/2 inches or less at the withers and/or brachycephalic dogs over the age of 7 years.

Large Open: for dogs over 17-1/2 inches at the withers who have not achieved the title of LCC.

Large Excellent: is for dogs over 17-1/2 inches at the withers who have achieved the title of LCC.

Large Veteran: for dogs over 17-1/2 inches at the withers who are over the age of 7 years.

Sighthound Mix Open: for dogs with a sighthound breed in its background who have not achieved the title of LCC.

Sighthound Mix Excellent: for dogs with sighthound breed in its background who have achieved the title of LCC.

Sighthound Mix Veteran: for dogs with sighthound breed in its background over the age of 7 years. When running as a stake within a regular ASFA trial, Small will run 50% of the ASFA course as laid out for the

sighthounds up to a maximum of 400 yards. All other stakes will run the full ASFA laid out course.

GENERAL INFORMATION

Conditions of Entry: All entries must be one year or older on the day of the trial. Stakes will be split into flights by public random draw if the entry in any regular stake is 20 or more. Bitches in season, lame hounds and hounds with breed disqualifications will be excused at roll call. Spayed, neutered, monorchid or cryptorchid hounds without breed disqualifications may be entered; hounds with breed disqualifications are not eligible to enter except in the Singles Stake. Hounds not present at the time of roll call will be scratched. All hounds will run twice, in trios if possible or braces (except in the Singles Stake), unless excused, dismissed or disqualified. Entries will not be acknowledged by email or phone.

COURSE PLANS:

Colorado Lure Coursing Association reserves the right to alter the course design(s) depending on field and/or weather conditions on the day of the trial.

Saturday February 21, 2026

765 yards, clock-wise for prelims and reversed for finals.

765 YARDS

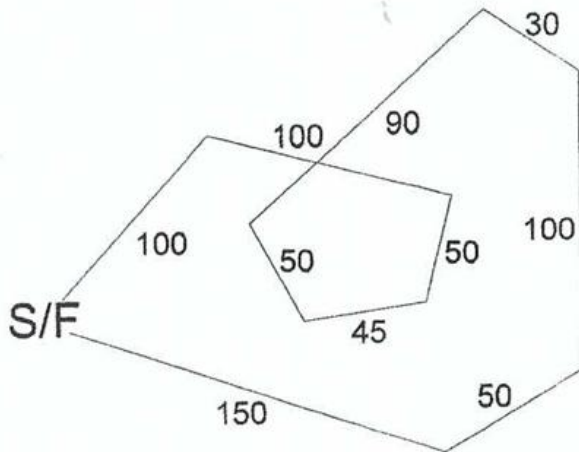

Sunday February 22, 2026

735 yards, clockwise for prelims and reversed for finals

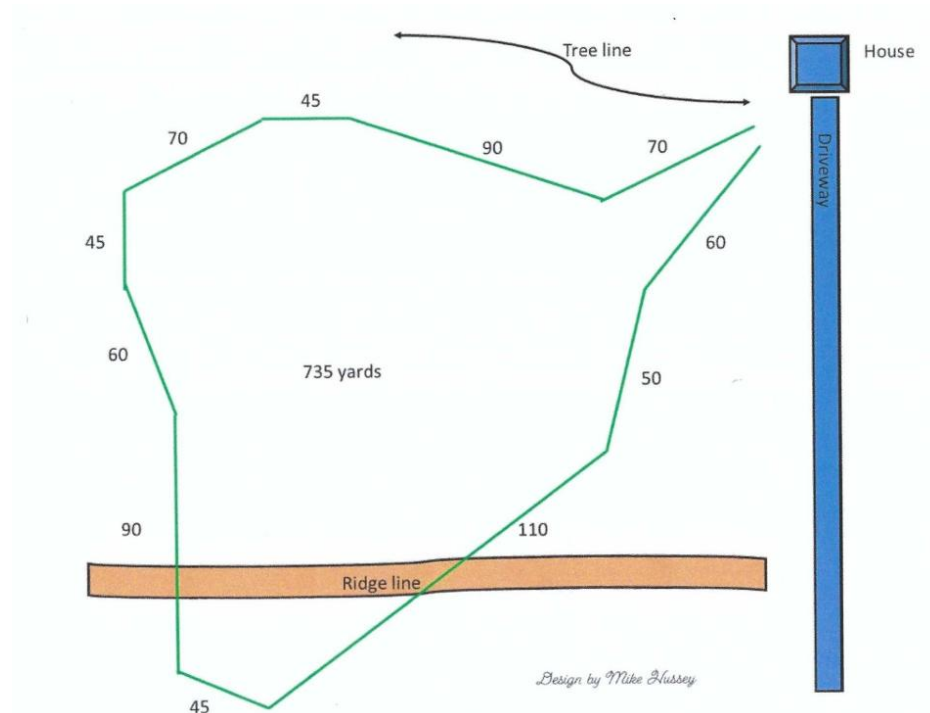

Warning: It is advised that all hounds entered be in top physical condition due to the altitude and rigorous conditions of the course, which will be run on natural terrain and may include such hazards as rocks, trees, cactus, vegetation, gopher holes, gullies, bodies of water and other obstacles.

ALL HOUNDS RUN AT THE OWNER'S SOLE RISK.

Information & Policies

- Port-a-pot on site.
- BRING WATER AND SHADE FOR YOUR HOUNDS.
- Bring FOOD – none offered by the Club.
- **Veterinarian –**
Saturday – Black Forest Veterinary Clinic 719-495-3666.
Sunday Animal Emergency Care, 5752 North Academy Blvd., (behind Petco) 719-260-7141.
- Due to dry conditions, smoking of any kind is prohibited on the field, Absolutely NO CAMPFIRES!
- PICK UP AFTER YOUR DOG AND YOURSELF!
- EQUIPMENT: Type of lure machine: battery-powered continuous-loop system. Back-up equipment will be available. Type of lures: highly visible plastic strips.
- A \$20.00 fee will be assessed for any returned checks. Persons exhibiting conduct detrimental to ASFA/CLCA/ any hound(s)/other person(s) will be asked to leave the trial site.
- There will be a \$5.00 fine for any owner who does not clean up after his/her hound and for any loose hound not competing in the course in progress.

How To Enter the Trial

1. Complete the entry form(s) – one entry form for each dog and each day that the dog is entered.
 - a. If this is the first time you have entered this dog in an ASFA trial, AND your dog has an AKC QC (qualified courser) OR an ASFA Certification, you MUST include a copy of that with your entry AND a copy of your registration certification (i.e., AKC, UKC, CKC, etc.)
 - b. If your dog does NOT have an AKC QC or ASFA Cert, you are allowed to run in SINGLES, but not the regular open stake. We offer certification AFTER the trial (Saturday ONLY.) Certification forms are included.
2. Email your entries to the Field Trial Secretary at rahwynd@yahoo.com ENTRIES THAT ARE EMAILED MUST BE ACCOMPANIED BY PAYMENT THROUGH the CLCA PayPal at: Deann.clcatreasurer@gmail.com. Please add \$1.00 per hound per day entered. If the original entries along with payment are not received the emailed entries will not constitute a valid entry.

How To Enter LCI

1. Complete the entry form(s) – one entry form for each dog and each day that the dog is entered.
 - a. If this is the first time you have entered this dog in an ASFA trial, you MUST include a copy of of your dog's registration certificate (i.e., AKC, UKC, CKC, etc.)
 - b. If your dog does NOT have a registration certificate and this is your first time entering in an ASFA trial you must complete the form titled: **Request for ASFA Lure Chasing Instinct Registration Number**
2. Email your entries to the Field Trial Secretary at rahwynd@yahoo.com ENTRIES THAT ARE EMAILED MUST BE ACCOMPANIED BY PAYMENT THROUGH the CLCA PayPal at: Deann.clcatreasurer@gmail.com. Please add \$1.00 per hound per day entered. If the original entries along with payment are not received the emailed entries will not constitute a valid entry.

Saturday February 21, 2026 :

Certifications and practices will be held AFTER the CLCA trial on Saturday, WEATHER AND MACHINERY PERMITTING

**All hounds will be inspected before running.
Lame hounds and bitches in season may NOT run.**

Certification: Any entry marked “First ASFA Point Trial” Must have an ASFA Hound Certification form and a copy of the hound’s registration papers, not required for NGA greyhounds, and must present them to the Field Trial Secretary along with your entry before entering a regular ASFA trial. This applies to “First ASFA point trial” hounds entered in the OPEN, VETERAN or PROVISIONAL stake. Certification forms will be available but MUST be completed prior to judging. Also have your hound’s registration number available for the Certification Form.

Certification: \$7.00, Owners wishing to certify a hound for competition are responsible for arranging a hound of the same breed, or similar running style, to run with his/her dog for the certification.

Practices: \$5.00 each dog

Please consider joining CLCA!
We’d love to have you.

Members are eligible to vote on topics at our twice-yearly meetings, to hold offices on the Boards, for the Top 10 year-end awards, and for our fun events and our annual banquet.

Dues are:

Individual - \$10/year

Associate - \$15/year

Family - \$20/year (2 voting members)

Membership application on the last page

Feel free to turn in at the trial or with your entries

Surfing the WEB? Check out the following websites:

www.clcaonline.com

www.asfa.org

Motels

The following will accept well-behaved dogs, for a fee:

- Travelodge, 6875 Space Village Ave, Colorado Springs, CO 80915, 719-596-5588
- Home2Suites, 1913 Aerotech Drive, Colorado Springs, CO 80916, 719-622-1000
- Homewood Suites, 2845 Zeppelin Rd, Colorado Springs, CO 80916, 719-418-0000

CHECK HOTELS FOR THEIR PET POLICIES

**** PLEASE CLEAN UP AFTER YOUR PETS**

Falcon Meadow Campgrounds, 11150 Hwy 24, Falcon – 719-495-2694
(Falcon is 5 miles west of the trial site)

RV CAMPING

Dry Camping Available on the field for \$15 a day.

You can make a difference, even if you can help out for an hour or so..

Easy ways to volunteer at a lure coursing field trial (and you don't even have to be a CLCA member):

Field Setup/Tear Down

- ◆ Come early (one hour before roll call) and start by carrying equipment.
- ◆ Learn as you go: how to place pulleys and tie downs; how to measure the course.
- ◆ Help pick up the course at the end of the day.

Inspection

- ◆ Check-in dogs; learn how to use the wicket. Help get the trial moving in the morning!

Field Clerk

- ◆ Volunteer for one or two breeds – get paperwork from the judges and deliver to the field trial secretary.
- ◆ Learn how scores are tabulated and recorded. Help correct math errors.
- ◆ The benefit is you will get a whole new perspective on the course and may learn by listening to the judges.

Paddock

- ◆ Volunteer for one or two breeds – keep the trial moving by making sure people know when they are up next.

Help your fellow participants

- ◆ Many people need help managing multiple dogs. Instead of sitting in your car, offer to hold a dog or release a dog.

Scoreboard

- ◆ Hang-up scoresheets... keep the trial moving.

Lure Operator

- ◆ Hang around and talk to the lure operator between courses.
- ◆ If you are interested, try running the lure around before the trial, at lunch or after the trial at practice.

Practice

- ◆ Give the volunteers who have been working all day a break!
- ◆ Take the practice list, inspect the dogs, call out the names.

THANK YOU FOR VOLUNTEERING. Everyone will appreciate your efforts, and the trial will run more smoothly.

Whether or not you are a CLCA member, please consider volunteering at this trial! If you have experience and are willing to work a job or if you wish to apprentice to learn a job, please fill out the form below and return it with your entry to the Field Trial Secretary. As an apprentice you will be paired with a person who knows the job so that you will have one-on-one attention.

I will work on: ____ Saturday ____ Sunday

I will apprentice on: ____ Saturday ____ Sunday

Name: _____

Phone: _____

Email: _____

I am entering dogs of these breeds on

Saturday: _____

I am entering dogs of these breeds on

Sunday: _____

Check jobs you are willing to do or learn the day of the trial.

	<u>EXPERIENCED</u>	<u>APPRENTICE</u>
Field Set UP	_____	_____
Roll Call	_____	_____
Paddock	_____	_____
Huntmaster	_____	_____
Lure Operator	_____	_____
Field Clerk	_____	_____
Field Tear Down	_____	_____

THANK YOU FOR VOLUNTEERING!!

OFFICIAL AMERICAN SIGHTHOUND FIELD ASSOCIATION ENTRY FORM
COLORADO LURE COURSING ASSOCIATION ALL BREED ASFA LURE FIELD TRIAL
SATURDAY FEBRUARY 21, 2026

FALCON INSTITUTE FOR ADVANCED COURSING STUDIES, FALCON, COLORADO
EARLY ENTRIES close 2/18, 6pm: 17.00 1ST hound, \$14.00 2ND and \$12.00 each additional hound entered by same owner. DAY OF ENTRIES 25.00 per hound; close at 8:30 A.M. at FTS TABLE day of trial
Payable in US funds. Make checks payable to CLCA and mail with completed entry form to:
Deann Britton, 444 S Lima Cir, Aurora, CO 80012

Fee Paid _____ The Field Secretary cannot accept conditional, unsigned, incomplete or unpaid entries; please check your completed entry carefully

Breed:	Call Name:		
Registered Name of Hound:			
Stake: <input type="checkbox"/> Open <input type="checkbox"/> FCH <input type="checkbox"/> Veteran <input type="checkbox"/> Singles <input type="checkbox"/> Provisional		Additional Stakes <input type="checkbox"/> Kennel <input type="checkbox"/> Breeder <input type="checkbox"/> Bench	
Registration Number: (please write in registering body before number)			
<input type="checkbox"/> If possible, please separate my hounds	Date of Birth:	Sex: <input type="checkbox"/> Dog <input type="checkbox"/> Bitch	
Name of actual owner(s):			
Address:		Phone:	
City:	State:	Zip:	
E-mail (Optional)		(Optional) Region of Residence:	
Emergency Contact Name and Phone (Optional)			
<input type="checkbox"/> Check if this is the first ASFA trial for this hound. Attach a Hound Certification or waiver if entered in Open, Veterans, Provisional.			
<input type="checkbox"/> Check if this is a first-time entry, a copy of the official Registration of this hound must accompany this entry unless NGA.			
<input type="checkbox"/> Check if any information has changed since the last ASFA trial entry. Regarding _____			
<input type="checkbox"/> Check if this hound has been dismissed within the last 6 trials entered. Must be marked in order to qualify for a "clean" trial requirement.			

I CERTIFY that I am the actual owner of this dog, or that I am the duly authorized agent of the actual owner whose name I have entered above. In consideration of the acceptance of this entry and the opportunity to have this dog judged and to win prize money, ribbons, or trophies, I (we) agree to abide by the rules and regulations of the American Sighthound Field Association in effect at the time of this lure field trial, and by any additional rules and regulations appearing in the premium list for this lure field trial. I (we) agree that the club holding this lure field trial has the right to refuse this entry for cause, which the club shall deem to be sufficient. I (we) agree to hold this club, its members, directors, governors, officers, agents or other functionaries, any employees of the aforementioned parties and the owner(s) of the trial premises or grounds harmless from any claim for loss or injury which may be alleged to have been caused directly or indirectly to any person or thing by the act of this dog while in or upon the lure field trial premises or grounds or near any entrance thereto and I (we) personally assume all responsibility and liability for any such claim, and I (we) further agree to hold the aforementioned parties harmless from any claim loss of this dog by disappearance, theft damage or injury be caused or alleged to be caused by the negligence of the club or any of the aforementioned parties or by the negligence of any person or any other cause or causes. I (we) certify and represent that the dog entered is not a hazard to person or other dogs. This entry is submitted for acceptance of the forgoing representations and agreements.

SIGNATURE of owner or his agent
duly authorized to make this entry _____

Please separate the entries before submitting to FTS.

OFFICIAL AMERICAN SIGHTHOUND FIELD ASSOCIATION ENTRY FORM
COLORADO LURE COURSING ASSOCIATION ALL BREED ASFA LURE FIELD TRIAL
SATURDAY FEBRUARY 21, 2026

FALCON INSTITUTE FOR ADVANCED COURSING STUDIES, FALCON, COLORADO
EARLY ENTRIES close 2/18, 6pm: 17.00 1ST hound, \$14.00 2ND and \$12.00 each additional hound entered by same owner.
DAY OF ENTRIES 25.00 per hound; close at 8:30 A.M. at FTS TABLE day of trial
Payable in US funds. Make checks payable to CLCA and mail with completed entry form to:
Deann Britton, 444 S Lima Cir, Aurora, CO 80012

Fee Paid _____ The Field Secretary cannot accept conditional, unsigned, incomplete or unpaid entries; please check your completed entry carefully

Breed:	Call Name:		
Registered Name of Hound:			
Stake: <input type="checkbox"/> Open <input type="checkbox"/> FCH <input type="checkbox"/> Veteran <input type="checkbox"/> Singles <input type="checkbox"/> Provisional		Additional Stakes <input type="checkbox"/> Kennel <input type="checkbox"/> Breeder <input type="checkbox"/> Bench	
Registration Number: (please write in registering body before number)			
<input type="checkbox"/> If possible, please separate my hounds	Date of Birth:	Sex: <input type="checkbox"/> Dog <input type="checkbox"/> Bitch	
Name of actual owner(s):			
Address:		Phone:	
City:	State:	Zip:	
E-mail (Optional)		(Optional) Region of Residence:	
Emergency Contact Name and Phone (Optional)			
<input type="checkbox"/> Check if this is the first ASFA trial for this hound. Attach a Hound Certification or waiver if entered in Open, Veterans, Provisional.			
<input type="checkbox"/> Check if this is a first-time entry, a copy of the official Registration of this hound must accompany this entry unless NGA.			
<input type="checkbox"/> Check if any information has changed since the last ASFA trial entry. Regarding _____			
<input type="checkbox"/> Check if this hound has been dismissed within the last 6 trials entered. Must be marked in order to qualify for a "clean" trial requirement.			

I CERTIFY that I am the actual owner of this dog, or that I am the duly authorized agent of the actual owner whose name I have entered above. In consideration of the acceptance of this entry and the opportunity to have this dog judged and to win prize money, ribbons, or trophies, I (we) agree to abide by the rules and regulations of the American Sighthound Field Association in effect at the time of this lure field trial, and by any additional rules and regulations appearing in the premium list for this lure field trial. I (we) agree that the club holding this lure field trial has the right to refuse this entry for cause, which the club shall deem to be sufficient. I (we) agree to hold this club, its members, directors, governors, officers, agents or other functionaries, any employees of the aforementioned parties and the owner(s) of the trial premises or grounds harmless from any claim for loss or injury which may be alleged to have been caused directly or indirectly to any person or thing by the act of this dog while in or upon the lure field trial premises or grounds or near any entrance thereto and I (we) personally assume all responsibility and liability for any such claim, and I (we) further agree to hold the aforementioned parties harmless from any claim loss of this dog by disappearance, theft damage or injury be caused or alleged to be caused by the negligence of the club or any of the aforementioned parties or by the negligence of any person or any other cause or causes. I (we) certify and represent that the dog entered is not a hazard to person or other dogs. This entry is submitted for acceptance of the forgoing representations and agreements.

SIGNATURE of owner or his agent
duly authorized to make this entry _____

Please separate the entries before submitting to FTS.

OFFICIAL AMERICAN SIGHTHOUND FIELD ASSOCIATION ENTRY FORM
COLORADO LURE COURSING ASSOCIATION ALL BREED ASFA LURE FIELD TRIAL
SUNDAY FEBRUARY 22, 2026

FALCON INSTITUTE FOR ADVANCED COURSING STUDIES, FALCON, COLORADO
EARLY ENTRIES close 2/18, 6pm: 17.00 1ST hound, \$14.00 2ND and \$12.00 each additional hound entered by same owner. DAY OF ENTRIES 25.00 per hound; close at 8:30 A.M. at FTS TABLE day of trial
Payable in US funds. Make checks payable to CLCA and mail with completed entry form to:
Deann Britton, 444 S Lima Cir, Aurora, CO 80012

Fee Paid _____ The Field Secretary cannot accept conditional, unsigned, incomplete or unpaid entries; please check your completed entry carefully

Breed:	Call Name:		
Registered Name of Hound:			
Stake: <input type="checkbox"/> Open <input type="checkbox"/> FCH <input type="checkbox"/> Veteran <input type="checkbox"/> Singles <input type="checkbox"/> Provisional		Additional Stakes <input type="checkbox"/> Kennel <input type="checkbox"/> Breeder <input type="checkbox"/> Bench	
Registration Number: (please write in registering body before number)			
<input type="checkbox"/> If possible, please separate my hounds	Date of Birth:	Sex: <input type="checkbox"/> Dog <input type="checkbox"/> Bitch	
Name of actual owner(s):			
Address:		Phone:	
City:	State:	Zip:	
E-mail (Optional)		(Optional) Region of Residence:	
Emergency Contact Name and Phone (Optional)			
<input type="checkbox"/> Check if this is the first ASFA trial for this hound. Attach a Hound Certification or waiver if entered in Open, Veterans, Provisional.			
<input type="checkbox"/> Check if this is a first-time entry, a copy of the official Registration of this hound must accompany this entry unless NGA.			
<input type="checkbox"/> Check if any information has changed since the last ASFA trial entry. Regarding _____			
<input type="checkbox"/> Check if this hound has been dismissed within the last 6 trials entered. Must be marked in order to qualify for a "clean" trial requirement.			

I CERTIFY that I am the actual owner of this dog, or that I am the duly authorized agent of the actual owner whose name I have entered above. In consideration of the acceptance of this entry and the opportunity to have this dog judged and to win prize money, ribbons, or trophies, I (we) agree to abide by the rules and regulations of the American Sighthound Field Association in effect at the time of this lure field trial, and by any additional rules and regulations appearing in the premium list for this lure field trial. I (we) agree that the club holding this lure field trial has the right to refuse this entry for cause, which the club shall deem to be sufficient. I (we) agree to hold this club, its members, directors, governors, officers, agents or other functionaries, any employees of the aforementioned parties and the owner(s) of the trial premises or grounds harmless from any claim for loss or injury which may be alleged to have been caused directly or indirectly to any person or thing by the act of this dog while in or upon the lure field trial premises or grounds or near any entrance thereto and I (we) personally assume all responsibility and liability for any such claim, and I (we) further agree to hold the aforementioned parties harmless from any claim loss of this dog by disappearance, theft damage or injury be caused or alleged to be caused by the negligence of the club or any of the aforementioned parties or by the negligence of any person or any other cause or causes. I (we) certify and represent that the dog entered is not a hazard to person or other dogs. This entry is submitted for acceptance of the forgoing representations and agreements.

SIGNATURE of owner or his agent
duly authorized to make this entry _____

Please separate the entries before submitting to FTS.

OFFICIAL AMERICAN SIGHTHOUND FIELD ASSOCIATION ENTRY FORM
COLORADO LURE COURSING ASSOCIATION ALL BREED ASFA LURE FIELD TRIAL
SUNDAY FEBRUARY 22, 2026

FALCON INSTITUTE FOR ADVANCED COURSING STUDIES, FALCON, COLORADO
EARLY ENTRIES close 2/18, 6pm: 17.00 1ST hound, \$14.00 2ND and \$12.00 each additional hound entered by same owner. DAY OF ENTRIES 25.00 per hound; close at 8:30 A.M. at FTS TABLE day of trial
Payable in US funds. Make checks payable to CLCA and mail with completed entry form to:
Deann Britton, 444 S. Lima Cir, Aurora, CO 80012

Fee Paid _____ The Field Secretary cannot accept conditional, unsigned, incomplete or unpaid entries; please check your completed entry carefully

Breed:	Call Name:		
Registered Name of Hound:			
Stake: <input type="checkbox"/> Open <input type="checkbox"/> FCH <input type="checkbox"/> Veteran <input type="checkbox"/> Singles <input type="checkbox"/> Provisional		Additional Stakes <input type="checkbox"/> Kennel <input type="checkbox"/> Breeder <input type="checkbox"/> Bench	
Registration Number: (please write in registering body before number)			
<input type="checkbox"/> If possible, please separate my hounds	Date of Birth:	Sex: <input type="checkbox"/> Dog <input type="checkbox"/> Bitch	
Name of actual owner(s):			
Address:		Phone:	
City:	State:	Zip:	
E-mail (Optional)		(Optional) Region of Residence:	
Emergency Contact Name and Phone (Optional)			
<input type="checkbox"/> Check if this is the first ASFA trial for this hound. Attach a Hound Certification or waiver if entered in Open, Veterans, Provisional.			
<input type="checkbox"/> Check if this is a first-time entry, a copy of the official Registration of this hound must accompany this entry unless NGA.			
<input type="checkbox"/> Check if any information has changed since the last ASFA trial entry. Regarding _____			
<input type="checkbox"/> Check if this hound has been dismissed within the last 6 trials entered. Must be marked in order to qualify for a "clean" trial requirement.			

I CERTIFY that I am the actual owner of this dog, or that I am the duly authorized agent of the actual owner whose name I have entered above. In consideration of the acceptance of this entry and the opportunity to have this dog judged and to win prize money, ribbons, or trophies, I (we) agree to abide by the rules and regulations of the American Sighthound Field Association in effect at the time of this lure field trial, and by any additional rules and regulations appearing in the premium list for this lure field trial. I (we) agree that the club holding this lure field trial has the right to refuse this entry for cause, which the club shall deem to be sufficient. I (we) agree to hold this club, its members, directors, governors, officers, agents or other functionaries, any employees of the aforementioned parties and the owner(s) of the trial premises or grounds harmless from any claim for loss or injury which may be alleged to have been caused directly or indirectly to any person or thing by the act of this dog while in or upon the lure field trial premises or grounds or near any entrance thereto and I (we) personally assume all responsibility and liability for any such claim, and I (we) further agree to hold the aforementioned parties harmless from any claim loss of this dog by disappearance, theft damage or injury be caused or alleged to be caused by the negligence of the club or any of the aforementioned parties or by the negligence of any person or any other cause or causes. I (we) certify and represent that the dog entered is not a hazard to person or other dogs. This entry is submitted for acceptance of the forgoing representations and agreements.

SIGNATURE of owner or his agent
duly authorized to make this entry _____

Please separate the entries before submitting to FTS.

OFFICIAL AMERICAN SIGHTHOUND FIELD ASSOCIATION

LCI ENTRY FORM

COLORADO LURE COURSEING ASSOCIATION ALL BREED ASFA LURE FIELD TRIAL

SATURDAY FEBRUARY 21,2026 **LIMIT 15 DOGS TOTAL**

FALCON INSTITUTE FOR ADVANCED COURSEING STUDIES, FALCON. COLORADO

EARLY ENTRIES close 2/18, 6pm: 17.00 1ST hound, \$14.00 2ND and \$12.00 each additional hound entered by same owner. DAY OF ENTRIES 25.00 per hound; close at 8:30 A.M. at FTS TABLE day of trial
Payable in US funds. Make checks payable to CLCA and mail with completed entry form to:

Deann Britton, 444 S Lima Cir, Aurora, CO 80012

Fee Paid _____ The Field Secretary cannot accept conditional, unsigned, incomplete or unpaid entries; please check your completed entry carefully.

Breed:		Call Name:	
Registered Name of dog:			
Stake: <input type="checkbox"/> LCI-Small <input type="checkbox"/> LCI-Large <input type="checkbox"/> LCI-Sighthound Mix <input type="checkbox"/> Open <input type="checkbox"/> Excellent <input type="checkbox"/> Veteran			
Registration Number: (please write in registering body before number)			
Date of Birth:		Sex: <input type="checkbox"/> Dog <input type="checkbox"/> Bitch	
Name of actual owner(s):			
Address:		Phone:	
City:		State:	Zip:
E-mail		(Optional) Region of Residence:	
Emergency Contact Name and Phone (Optional)			
<input type="checkbox"/> Check if this is a first-time entry, a copy of the official Registration of this hound must accompany this entry. (i.e., AKC Registration form, PAL registration, Canine Partner, etc.)			
<input type="checkbox"/> Check if any information has changed since the last ASFA trial entry. Regarding _____			

I CERTIFY that I am the actual owner of this dog, or that I am the duly authorized agent of the actual owner whose name I have entered above. In consideration of the acceptance of this entry and the opportunity to have this dog judged and to win prize money, ribbons, or trophies, I (we) agree to abide by the rules and regulations of the American Sighthound Field Association in effect at the time of this lure field trial, and by any additional rules and regulations appearing in the premium list for this lure field trial. I (we) agree that the club holding this lure field trial has the right to refuse this entry for cause, which the club shall deem to be sufficient. I (we) agree to hold this club, its members, directors, governors, officers, agents or other functionaries, any employees of the aforementioned parties and the owner(s) of the trial premises or grounds harmless from any claim for loss or injury which may be alleged to have been caused directly or indirectly to any person or thing by the act of this dog while in or upon the lure field trial premises or grounds or near any entrance thereto and I (we) personally assume all responsibility and liability for any such claim, and I (we) further agree to hold the aforementioned parties harmless from any claim loss of this dog by disappearance, theft damage or injury be caused or alleged to be caused by the negligence of the club or any of the aforementioned parties or by the negligence of any person or any other cause or causes. I (we) certify and represent that the dog entered is not a hazard to person or other dogs. This entry is submitted for acceptance of the forgoing representations and agreements.

SIGNATURE of owner or his agent
duly authorized to make this entry _____

Please separate the entries before submitting to FTS.

OFFICIAL AMERICAN SIGHTHOUND FIELD ASSOCIATION

LCI ENTRY FORM

COLORADO LURE COURSEING ASSOCIATION ALL BREED ASFA LURE FIELD TRIAL

SUNDAY FEBRUARY 22, 2026 **LIMIT 15 DOGS TOTAL**

FALCON INSTITUTE FOR ADVANCED COURSEING STUDIES, FALCON. COLORADO

EARLY ENTRIES close 2/18, 6pm: 17.00 1ST hound, \$14.00 2ND and \$12.00 each additional hound entered by same owner. DAY OF ENTRIES 25.00 per hound; close at 8:30 A.M. at FTS TABLE day of trial
Payable in US funds. Make checks payable to CLCA and mail with completed entry form to:

Deann Britton, 444 S Lima Cir, Aurora, CO 80012

Fee Paid _____ The Field Secretary cannot accept conditional, unsigned, incomplete or unpaid entries; please check your completed entry carefully.

Breed:		Call Name:	
Registered Name of dog:			
Stake: <input type="checkbox"/> LCI-Small <input type="checkbox"/> LCI-Large <input type="checkbox"/> LCI-Sighthound Mix <input type="checkbox"/> Open <input type="checkbox"/> Excellent <input type="checkbox"/> Veteran			
Registration Number: (please write in registering body before number)			
Date of Birth:		Sex: <input type="checkbox"/> Dog <input type="checkbox"/> Bitch	
Name of actual owner(s):			
Address:		Phone:	
City:		State:	Zip:
E-mail		(Optional) Region of Residence:	
Emergency Contact Name and Phone (Optional)			
<input type="checkbox"/> Check if this is a first-time entry, a copy of the official Registration of this hound must accompany this entry. (i.e., AKC Registration form, PAL registration, Canine Partner, etc.)			
<input type="checkbox"/> Check if any information has changed since the last ASFA trial entry. Regarding _____			

I CERTIFY that I am the actual owner of this dog, or that I am the duly authorized agent of the actual owner whose name I have entered above. In consideration of the acceptance of this entry and the opportunity to have this dog judged and to win prize money, ribbons, or trophies, I (we) agree to abide by the rules and regulations of the American Sighthound Field Association in effect at the time of this lure field trial, and by any additional rules and regulations appearing in the premium list for this lure field trial. I (we) agree that the club holding this lure field trial has the right to refuse this entry for cause, which the club shall deem to be sufficient. I (we) agree to hold this club, its members, directors, governors, officers, agents or other functionaries, any employees of the aforementioned parties and the owner(s) of the trial premises or grounds harmless from any claim for loss or injury which may be alleged to have been caused directly or indirectly to any person or thing by the act of this dog while in or upon the lure field trial premises or grounds or near any entrance thereto and I (we) personally assume all responsibility and liability for any such claim, and I (we) further agree to hold the aforementioned parties harmless from any claim loss of this dog by disappearance, theft damage or injury be caused or alleged to be caused by the negligence of the club or any of the aforementioned parties or by the negligence of any person or any other cause or causes. I (we) certify and represent that the dog entered is not a hazard to person or other dogs. This entry is submitted for acceptance of the forgoing representations and agreements.

SIGNATURE of owner or his agent
duly authorized to make this entry _____

Please separate the entries before submitting to FTS.

OFFICIAL AMERICAN SIGHTHOUND FIELD ASSOCIATION
Request for ASFA Lure Chasing Instinct Registration Number

Fee Paid _____ This form is for dogs without any registration number from another registering body.

Please print legibly.

Breed:	Call Name:		
Registered Name of Dog:			
FTS will circle Size after wicketing at Inspection: Size Small: up to 17½ inches (or brachycephalic) Size Large: over 17½ inches Registration Number: (To be assigned by ASFA records coordinator.)			
Date of Birth:	Sex:	<input type="checkbox"/> Dog <input type="checkbox"/> Bitch	
Name of actual owner(s):			
Address:		Phone:	
City:	State:	Zip:	
E-mail	Region of Residence: (Optional)		
Emergency Contact Name and Phone			

This top portion is to be submitted with the \$10 fee to the Field Trial Secretary. First time trial entry on separate form.

_____ was entered in the _____
(Dog's Name) (ASFA Club Name)

ASFA trial held on _____. The dog was wicketed at inspection and is
(Date)
registered as Size _____. The fee of \$10 was received by the FTS and
submitted to the ASFA Records Coordinator.

Printed name of Field Trial Secretary

Signature of Field Trial Secretary

(Owner is to retain this receipt as proof of registration until notified by the ASFA.)

OFFICIAL AMERICAN SIGHTHOUND FIELD ASSOCIATION
Request for ASFA Lure Chasing Instinct Registration Number

Fee Paid _____ This form is for dogs without any registration number from another registering body.

Please print legibly.

Breed:	Call Name:		
Registered Name of Dog:			
FTS will circle Size after wicketing at Inspection: Size Small: up to 17½ inches (or brachycephalic) Size Large: over 17½ inches Registration Number: (To be assigned by ASFA records coordinator.)			
Date of Birth:	Sex:	<input type="checkbox"/> Dog <input type="checkbox"/> Bitch	
Name of actual owner(s):			
Address:		Phone:	
City:	State:	Zip:	
E-mail	Region of Residence: (Optional)		
Emergency Contact Name and Phone			

This top portion is to be submitted with the \$10 fee to the Field Trial Secretary. First time trial entry on separate form.

_____ was entered in the _____
(Dog's Name) (ASFA Club Name)

ASFA trial held on _____. The dog was wicketed at inspection and is
(Date)
registered as Size _____. The fee of \$10 was received by the FTS and
submitted to the ASFA Records Coordinator.

Printed name of Field Trial Secretary

Signature of Field Trial Secretary

(Owner is to retain this receipt as proof of registration until notified by the ASFA.)

**AMERICAN SIGHTHOUND FIELD ASSOCIATION
HOUND CERTIFICATION**

Rule effective October 1, 1994: Ch. V, Sec. 4 (a) OPEN STAKE: *To be eligible to enter the open stake, a hound must have been certified by a licensed judge within the year preceding the closing date for the entry or have previously competed in the Open Stake.* This eligibility requirement also applies to a hound entered in the Veteran Stake, which has not competed in Open previously. Please complete this portion of this form and attach it to the entry form for the hound's first entry, including an entry for a Fun Trial.

Registered Name of Hound: _____

Registration Number: _____ Breed: _____

Registered Owner's Name: _____

I hereby certify that on (date) _____, the above named hound completed a lure course of at least 500 yards, running with another hound of the same breed (or another breed with a similar running style). During the course the above named hound showed no inclination to interfere with the other hound. I further certify that I am a licensed judge for the ASFA.

Name of Licensed Judge: _____

Signature: _____ Date: _____

I hereby certify that the hound running in the certification course is the hound identified above and that information provided on this form is true and correct.

Signature: _____ Date: _____

Owner or Authorized Agent of Hound

This certification form must be attached to the entry form the first time this hound is entered in an open or veteran stake. Any hound entered in open, or veteran (as a first time entered hound), which has not been certified, shall be declared ineligible by the records coordinator and shall forfeit any points and placements awarded.

PLEASE RETAIN A COPY FOR YOUR RECORDS.

**AMERICAN SIGHTHOUND FIELD ASSOCIATION
HOUND CERTIFICATION WAIVER**

Waiver of Requirement: *This requirement will be waived for a hound that has earned a lure coursing title from another recognized organization, if such title requires competition, and if a waiver for such title has been approved by the ASFA, or a CKC Hound Certification Form.* If your hound qualifies for a waiver, complete this portion of this form and attach it to your entry form. Proof of waivers must accompany this certification form.

Registered Name of Hound: _____

Registration Number: _____ Breed: _____

Registered Owner's Name: _____

CKC: FCH FCHX

AKC: QC SC FC

Hound Certification previously submitted.

I hereby certify that the hound identified above has completed the requirements for the title indicated above (or that the required Certification was previously submitted) and that the information provided on this form is true and correct.

Signature: _____ Date: _____

Owner or Authorized Agent of Hound

**AMERICAN SIGHTHOUND FIELD ASSOCIATION
HOUND CERTIFICATION**

Rule effective October 1, 1994: Ch. V, Sec. 4 (a) OPEN STAKE: *To be eligible to enter the open stake, a hound must have been certified by a licensed judge within the year preceding the closing date for the entry or have previously competed in the Open Stake.* This eligibility requirement also applies to a hound entered in the Veteran Stake, which has not competed in Open previously. Please complete this portion of this form and attach it to the entry form for the hound's first entry, including an entry for a Fun Trial.

Registered Name of Hound: _____

Registration Number: _____ Breed: _____

Registered Owner's Name: _____

I hereby certify that on (date) _____, the above named hound completed a lure course of at least 500 yards, running with another hound of the same breed (or another breed with a similar running style). During the course the above named hound showed no inclination to interfere with the other hound. I further certify that I am a licensed judge for the ASFA.

Name of Licensed Judge: _____

Signature: _____ Date: _____

I hereby certify that the hound running in the certification course is the hound identified above and that information provided on this form is true and correct.

Signature: _____ Date: _____

Owner or Authorized Agent of Hound

This certification form must be attached to the entry form the first time this hound is entered in an open or veteran stake. Any hound entered in open or veteran (as a first time entered hound), which has not been certified, shall be declared ineligible by the records coordinator and shall forfeit any points and placements awarded.

PLEASE RETAIN A COPY FOR YOUR RECORDS.

**AMERICAN SIGHTHOUND FIELD ASSOCIATION
HOUND CERTIFICATION WAIVER**

Waiver of Requirement: *This requirement will be waived for a hound that has earned a lure coursing title from another recognized organization, if such title requires competition, and if a waiver for such title has been approved by the ASFA, or a CKC Hound Certification Form.* If your hound qualifies for a waiver, complete this portion of this form and attach it to your entry form. Proof of waivers must accompany this certification form.

Registered Name of Hound: _____

Registration Number: _____ Breed: _____

Registered Owner's Name: _____

CKC: FCH FCHX

AKC: QC SC FC

Hound Certification previously submitted.

I hereby certify that the hound identified above has completed the requirements for the title indicated above (or that the required Certification was previously submitted) and that the information provided on this form is true and correct.

Signature: _____ Date: _____

Owner or Authorized Agent of Hound